



## **Operating Instructions**



**Varioset Standard  
VEIT 4442**



## After-sales service

**For after-sales service please contact  
the Veit representative in your country.**



**GmbH & Co.**

**Justus - von - Liebig - Str. 15**

**D - 86899 Landsberg a. L.**

**Tel. 08191 / 479 - 176**

**Fax. 08191 / 479 - 149**

## Table of Contents:

<b>1 General Drawing</b>	<b>4</b>
<b>2 Warnings</b>	<b>5</b>
<b>3 Technical Data</b>	<b>6</b>
<b>4 General Information</b>	<b>7</b>
4.1 Assembly	7
4.2 Electrical Connection	7
4.3 Switching On / Off	7
4.4 Transportation	7
4.5 Height Adjustment	7
<b>5 Assembly Instructions</b>	<b>8</b>
5.1 Varioset Standard	9
5.2 Air-Vent-Chimney and Air-Vent-Grill	10
<b>6 Maintenance and Service</b>	<b>11</b>
<b>7 Malfunctions and Troubleshooting</b>	<b>12</b>
<b>8 Spare Parts</b>	<b>13</b>
8.1 Drawing	13
8.2 Spare Parts List	14
<b>9 Circuit Diagrams</b>	<b>15</b>
9.1 Circuit Diagram 380-415V, 50/60Hz	15
9.2 Circuit Diagram, 3x200-220V, 50/60Hz	16
9.3 Circuit Diagram, 1x200-220V, 50/60Hz	17
<b>10 EC-Declaration of Conformity</b>	<b>18</b>

## 1 General Drawing

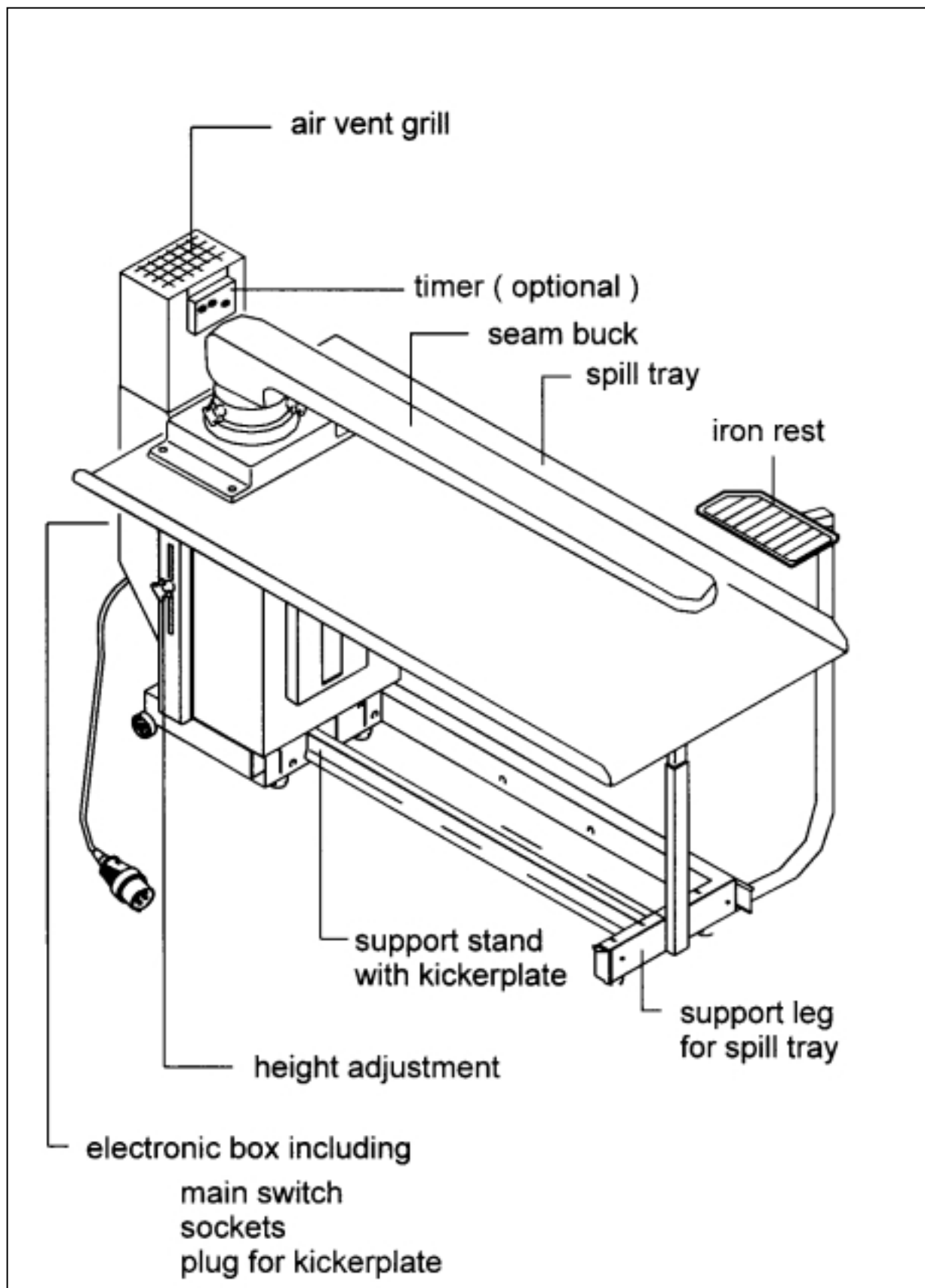

## 2 Warnings

1. The ironing table should only be operated when it is completely assembled (support stand, ironing surface, air-vent-chimney depending on equipment, air-vent-grill).
2. Only use the voltage and type of current shown on the machine plate.
3. Electrical faults must only be repaired by authorized personnel.
4. Disconnect the power supply before opening up.
5. The mains supply must be secured by the customer.
6. The unit is supplied with a plug. Do not connect without a plug. The plug must be easily accessible and must not be covered by any components.
7. Take note of the regulations of the local electric suppliers.
8. Use only Veit spare parts and accessories.
9. The ironing table must only be used for ironing with or without steam. Do not remove spots with solvents or other combustible or explosive materials.
10. Take care not to damage the connection cable when moving the table or adjusting the height.

### 3 Technical Data

Electrical data:		see machine plate
Year of construction:		see machine plate
Air volume max.		1000 m <sup>3</sup> /h
Measurements of the base module:	height width length weight height adjustment	660 mm/ 25,6 in 450 mm/ 17,7 in 550 mm/21,7 in 100 lbs/ 45 kg 755-900 mm/ 29,7 - 35,4 in
height with air-vent-chimney:		1500 mm / 59 in

## 4 General Information

### 4.1 Assembly

Please see special assembly instructions for the units and the additional units in section 5.

### 4.2 Electrical Connection

The device is fitted with a suitable plug; length of cable 4 m. Connect the unit within this distance.

**Direct supply without plug is not admitted!**

**Caution!**

The 3 phase motor is pole-changing. If the motor is running in reverse, phase L1 and L3 have to be reversed.

### 4.3 Switching On / Off

Main switch at the rear of the base unit.

Sockets are located at the rear of the base module.

The fuses are mounted on the PC-board. For removing them, please swing down the e-box.

### 4.4 Transportation

The unit can easily be moved by transportation wheels.

The transporting unit E 29 can be used for flat top and universal ironing tables.

### 4.5 Height Adjustment

Release the two star-grip bolts at the side to adjust the height. Take care that the connection cable cannot be damaged.

## 5 Assembly Instructions

**Please also note the positions marked with the numbers in the following figures.**

- 1      Mount the base module.
- 2      Pull the stabilizing profile out of the rectangular tube of the base frame. Remove the plastic cap on the corresponding side of the support stand and screw the base frame and the support stand on with the stabilizing profile. Then fasten the support stand by screws M 8x60 at the base module.
- 3      Unscrew the supporting plate at the top of the base module.
- 4      Mount the chimney or the air-vent-grill.
- 5      Mount the workplace illumination or the iron gantry.
- 6      Screw the leg support on the support stand.
- 7      Fasten the spill tray and the support for the ironing buck on the supporting plate ( screws M 8 mounted from down to up ) Put the unit on the base module and fasten the supporting plate with screws.
- 8      Mount the iron rest.
- 9      Push the kickerplate in the suitable position at the support stand and fix the cable with the self-adhesive clips. Connect the cable plug at the bottom of the electronic box.
- 10     Fix the cover on the ironing buck.
- 11     Adjust the ironing table at the final workplace to any unevenness of the floor by means of the height-adjustable rubber feet and fasten the counternuts of the foot adjustment.
- 12     Unscrew the two star grips at the base module to adjust the height.



## 5.1 Varioset Standard

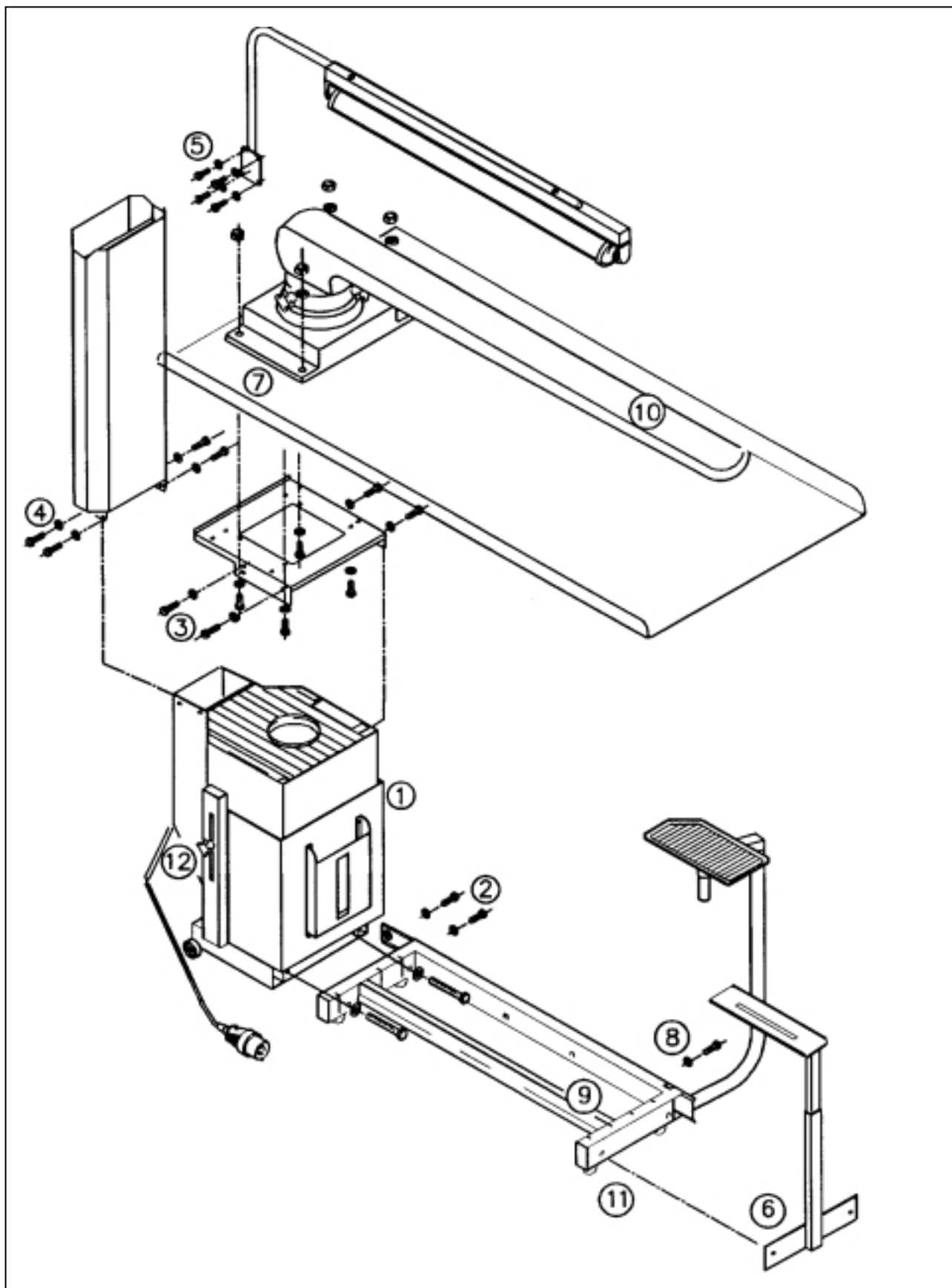

## 5.2 Air-Vent-Chimney and Air-Vent-Grill

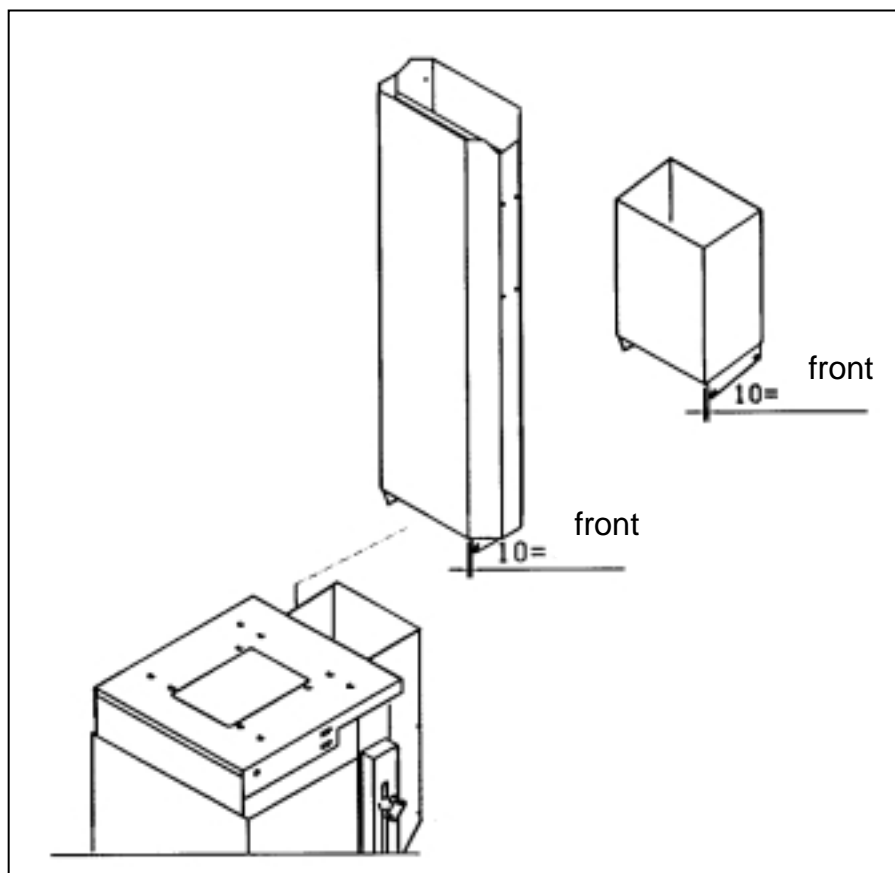

## 6 Maintenance and Service

after approx. 40 working hours or after 4 weeks	Clean the foam layer and the synthetic cover	In the washing machine at 30°C or with warm water by hand
after approx. 40 working hours or after 4 weeks	Check the Prefitt cover and the silicon layer. Clean them, if necessary	Use a hard brush and compressed air
approx. 3 times a year	Clean the impeller; please see instructions below	Clean the blades with a brush or compressed air depending on soiling. For removing the impeller, please see spare part drawing

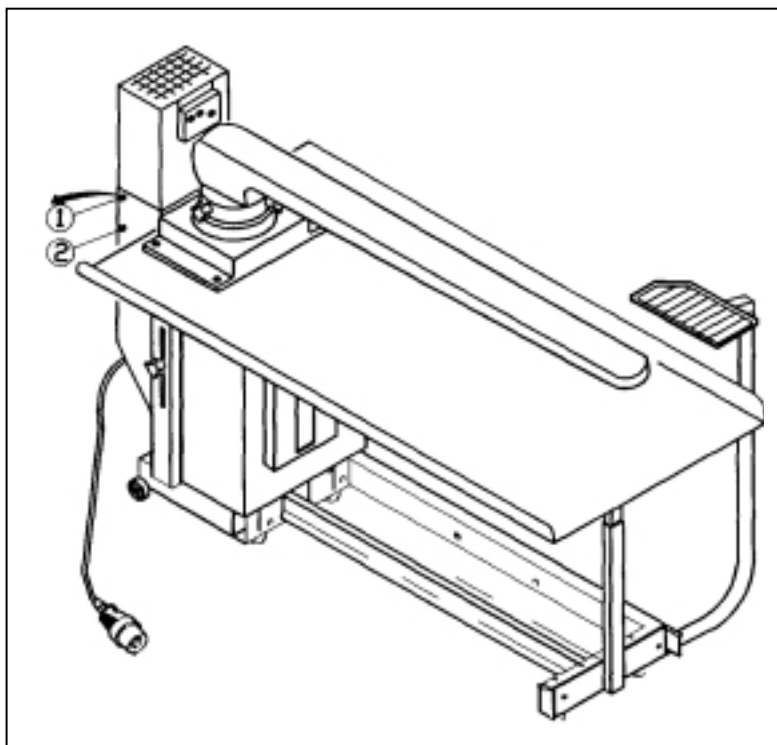

### Maintenance instructions Cleaning of the impeller

**Caution !**  
**Disconnect power supply**

Remove the screws (1) + (2) at the side and swing down the cover below the air-vent-grill or the air-vent-chimney.

Clean the impeller with a brush, compressed air or a vacuum cleaner.

## 7 Malfunctions and Troubleshooting

MALFUNCTIONS	CAUSE	TROUBLESHOOTING
Insufficient suction	Impeller rotates the wrong way round	Open the unit plug; invert phases L1 and L3
No suction	Impeller motor does not run	<ol style="list-style-type: none"> <li>1. Temperature protection in the motor switched off because of overheating; ready for operation after cooling down (approx. 15 min.)</li> <li>2. Test foot switch</li> <li>3. Remove electric box. Test contactor on the PC-board</li> </ol>
Fan motor runs loudly	Impeller dirty and therefore out-of-balance	Clean impeller ( see chapter 6 )

## 8 Spare Parts

### 8.1 Drawing

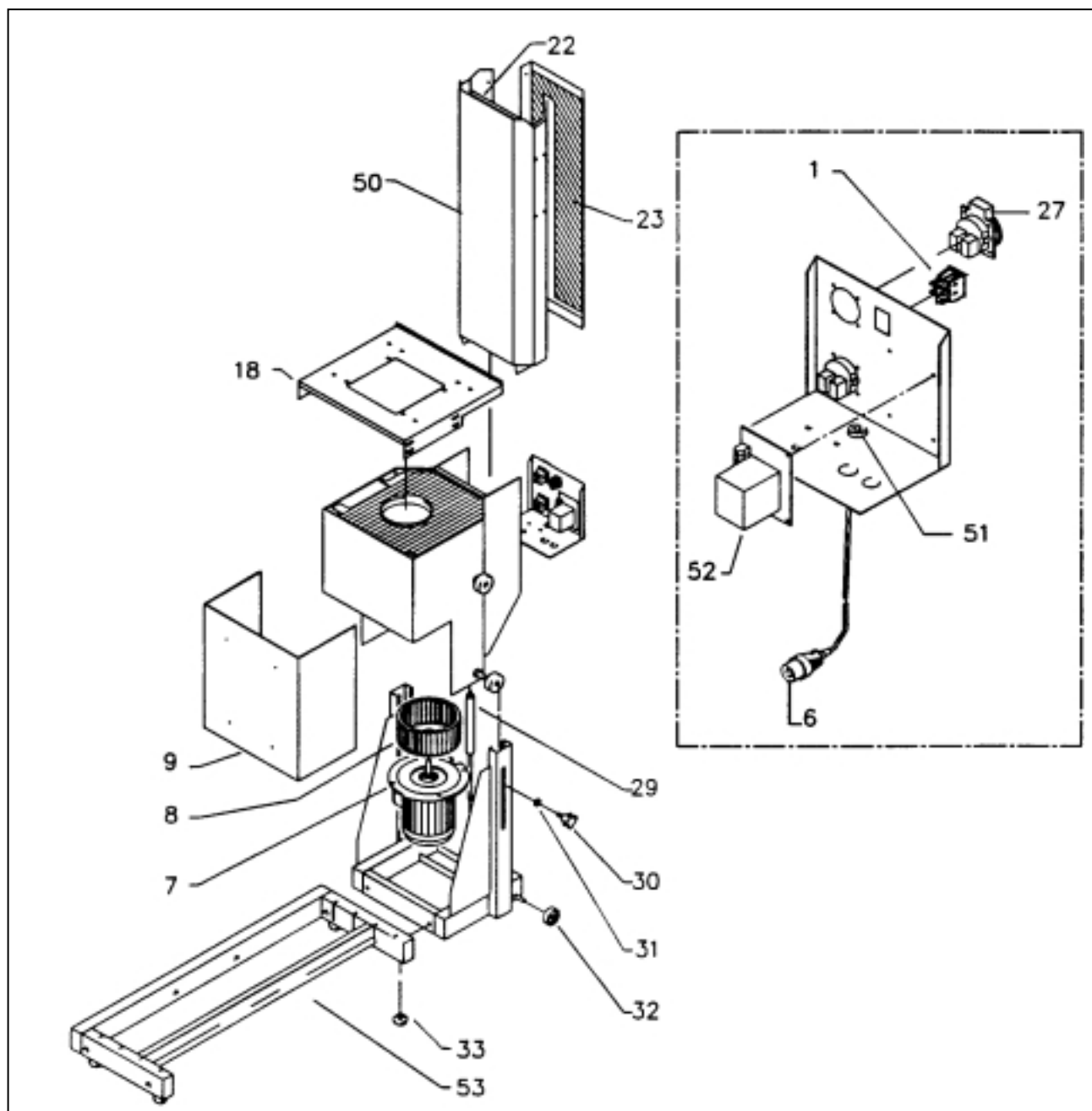

## 8.2 Spare Parts List

Pos.	Article-Number	Description
01	479 145 009 0	main switch with splash guard
06	444 701 556 0	connection cable with Euro-plug (CECON)
--	444 402 020 0	set of small parts / circuit, consisting of: distance bolt, distance bushing 7.5 + 13.5 long, nut M3, spring washer A3 and strain relief
07	444 704 001 0	3 ~ motor 0.55 kW, 180-254 V, 310-440 V / 50 Hz
--	444 704 005 0	3 ~ motor 1 kW, 200 -277 V / 60 Hz
--	444 704 010 0	1 ~ motor 0.55 kW, 220-240 V / 50 Hz
--	444 704 008 0	1 ~ motor 1 kW, 220-240 V / 60 Hz
--	444 703 001 0	motor gasket
08	444 133 002 0	impeller 180x92 turning counter-clockwise for 50 Hz
--	444 703 003 0	impeller 180x74 turning counter-clockwise for 60 Hz
--	444 401 079 L	distance tube / impeller 180x74 / VS 2 (at 60 Hz)
--	444 402 027 L	ring / impeller 185x40 / VS 2 (at 60 Hz)
09	444 401 043 0	plastic front cover
18	444 701 527 L	casing cover
22	544 401 009 0	insulating board 610x460x25
23	549 770 010 0	insulating board 200x760x15
29	916 021 014 0	gas pressure spring 90 kg
30/31	444 402 023 0	clamping unit for height-adjustment, consisting of: star handle screw (2x) and washer (2x)
32	444 701 045 0	wheel with ball bearing
33	444 132 510 0	rubber foot complete
50	244 402 002 0	air-vent-chimney complete (without display)
51	440 000 037 0	small socket 4 pins
52	444 404 002 0	main PC-board for 3x220 V; 50/60 Hz, 3x200 V 50/60 Hz, 380 V / 50 Hz, 400 V / 50 Hz, 415 V / 50 Hz
--	443 025 013 0	fuse 10 AM 5 x 20 (10 pcs.)
--	929 055 034 0	fuse 1.4 AM 5 x 20 (10 pcs.)
53	540 202 005 0	kickerplate complete / VS Standard
--	444 705 006 0	switch / kickerplate standard

## 9 Circuit Diagrams

### 9.1 Circuit Diagram 380-415V, 50/60Hz

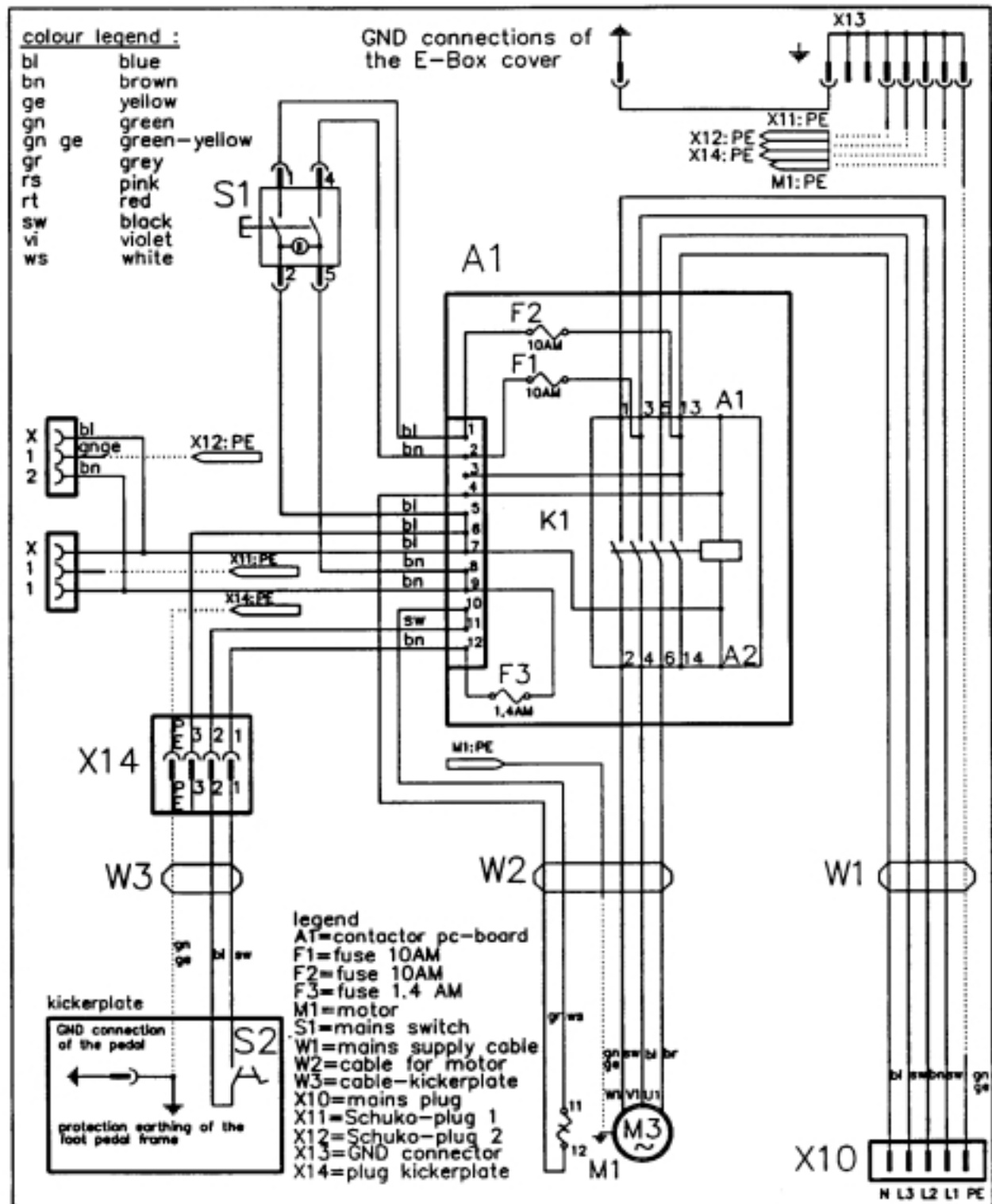

## 9.2 Circuit Diagram, 3x200-220V, 50/60Hz

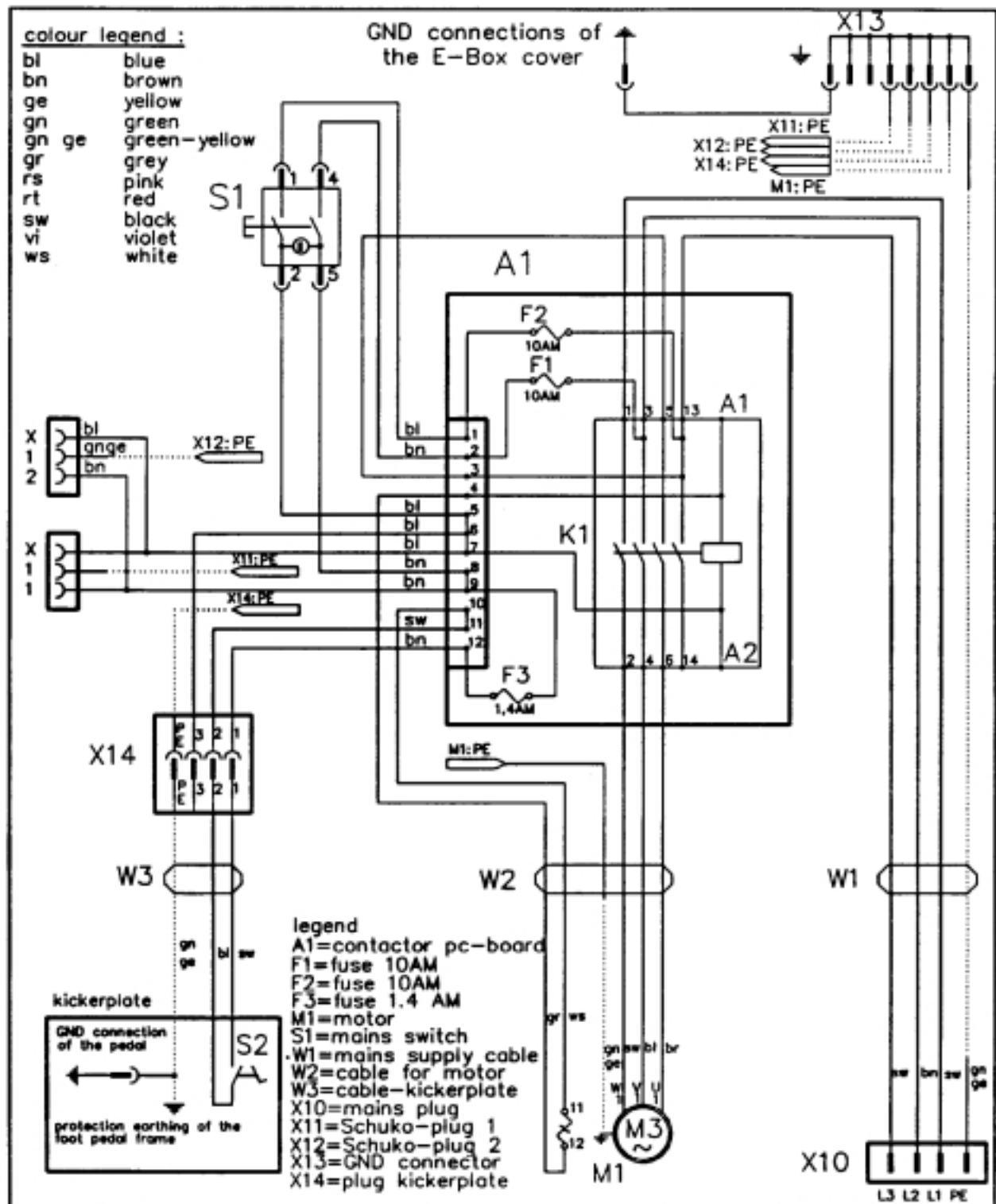



### 9.3 Circuit Diagram, 1x200-220V, 50/60Hz

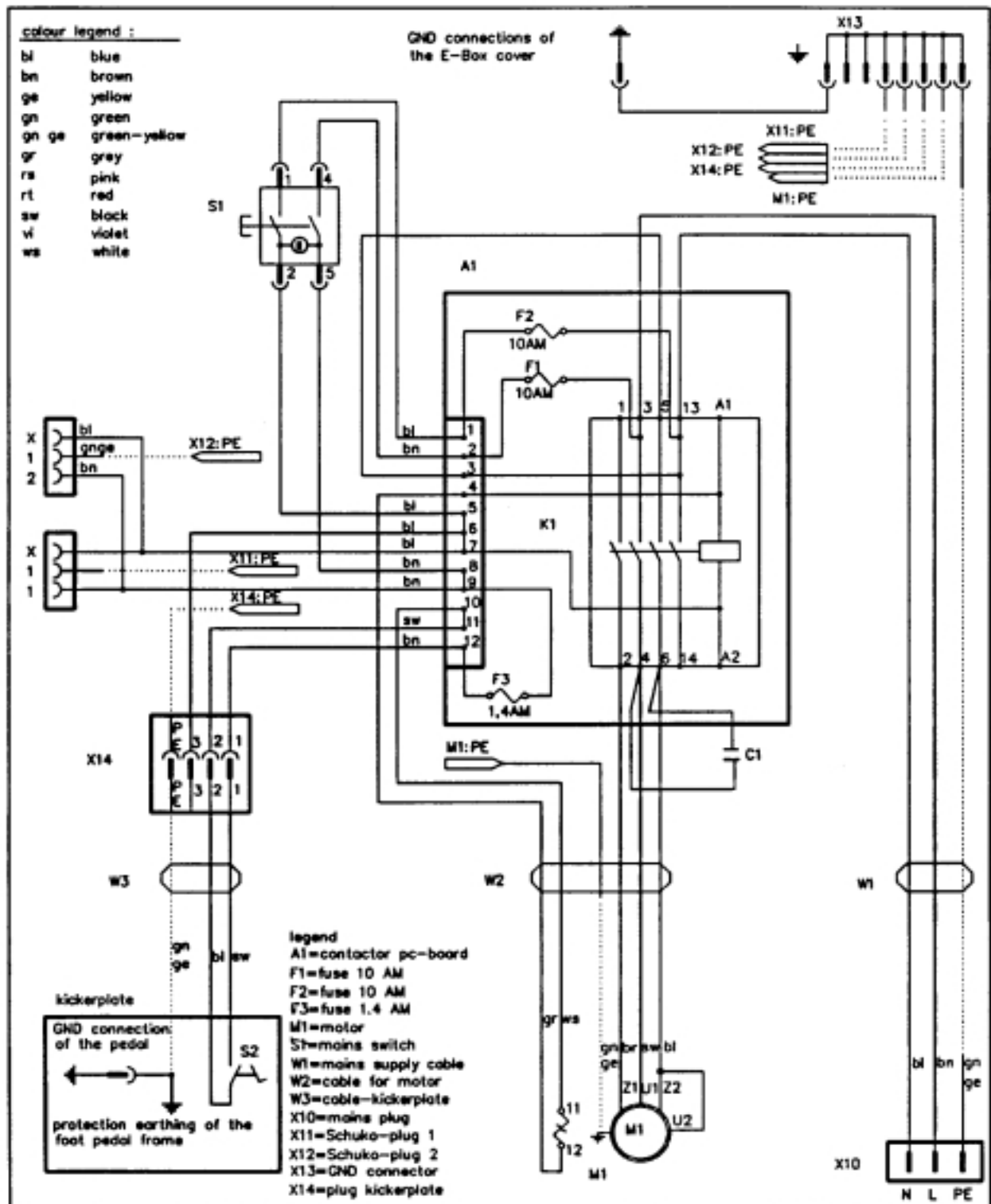

## 10 EC-Declaration of Conformity

**EG-Konformitätserklärung/ EC declaration of conformity / Déclaration "CE" de conformité  
EF-overensstemmelseserklæring/ EG-verklaring van overeenstemming  
Declaración CE de conformidad / Dichiarazione CE di conformità / Declaração CE de conformidade**

**VEIT Varioset S&B / Standard**

Seriennummer: \_\_\_\_\_

Hiermit erklären wir, daß die Bauart des genannten Geräts in der gelieferten Ausführung folgenden einschlägigen Richtlinien entspricht

Herewith we declare that the supplied model complies with the following provisions applying to it

Par la présente, nous déclarons, que le modèle correspond aux dispositions pertinentes suivantes

Herved erklæres, at produkttypen er i overensstemmelse med følgende bestemmelser

Hiermede verklaren wij, dat de in de handel gebrachte machine voldoet aan de eisen van de in het vervolg genoemde bepalingen

Por la presente, declaramos que el modelo suministrado satisface las disposiciones pertinentes siguientes Si dichiara che il modello fornito della è conforme alle seguenti disposizioni pertinenti

Com a presente, declaramos que o modelo fornecido da está em conformidade com as disposições pertinentes, a saber

**EG-Richtlinie Maschinen 98/37, Richtlinie Elektromagnetische Verträglichkeit 89/336**

Angewandte harmonisierte Normen, insbesondere

Applied harmonized standards, in particular

Normes harmonisées utilisées, notamment:

Harmoniserede standarder, der blev anvendt, i særdeleshed

Gebruikte geharmoniseerde normen, in het bijzonder

Normas armonizadas utilizadas, particularmente

Norme armonizzate applicate in particolare

Normas harmonizadas utilizadas, em particular

**EN 292-1, EN 292-2, EN 55011/class B, EN 50082-2, EN 50140, EN 50141, EN 61000-4-2,  
EN 61000-4-4, EN 60204-1**

Landsberg, 27.09.2000

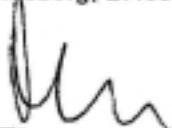

D. Töwe

Geschäftsführer / Vice President & Managing Director

**VEIT GmbH & Co.  
Justus-von-Liebig-Straße 15  
D-86899 Landsberg / Lech**

To:

VEIT - Service -

Justus-von-Liebig Str. 15

D- 86899 Landsberg / Lech

Germany

Fax: +49 (8191) 479 - 230

# Registration

VEIT always tries to improve its products. To do this, we need to be supported by you. We will register your answers which will enable us to inform you directly about any technical improvements.

## 1.) How did you become aware of the product?

- ☐ VEIT employee / dealer
 ☐ Internet  
☐ Exhibition \_\_\_\_\_
 ☐ Other \_\_\_\_\_  
☐ Magazine \_\_\_\_\_

## 2.) What is your opinion about the following points:

	good			bad	
Support at the sales decision	<input type="checkbox"/>	<input type="checkbox"/>	<input type="checkbox"/>	<input type="checkbox"/>	<input type="checkbox"/>
Installation	<input type="checkbox"/>	<input type="checkbox"/>	<input type="checkbox"/>	<input type="checkbox"/>	<input type="checkbox"/>
Instruction	<input type="checkbox"/>	<input type="checkbox"/>	<input type="checkbox"/>	<input type="checkbox"/>	<input type="checkbox"/>
Manual	<input type="checkbox"/>	<input type="checkbox"/>	<input type="checkbox"/>	<input type="checkbox"/>	<input type="checkbox"/>
Operation of the unit	<input type="checkbox"/>	<input type="checkbox"/>	<input type="checkbox"/>	<input type="checkbox"/>	<input type="checkbox"/>
Result of the operation	<input type="checkbox"/>	<input type="checkbox"/>	<input type="checkbox"/>	<input type="checkbox"/>	<input type="checkbox"/>
Quality of the machine	<input type="checkbox"/>	<input type="checkbox"/>	<input type="checkbox"/>	<input type="checkbox"/>	<input type="checkbox"/>

## 3.) Suggestions for improvement:

---



---



---

## Address:

Name: \_\_\_\_\_  
 Street: \_\_\_\_\_  
 Place/Country: \_\_\_\_\_  
 Phone: \_\_\_\_\_  
 Fax: \_\_\_\_\_

Thank you for your help!